

CONCEPT  
04

From London, England

# LAYERS OF CREATIVITY

Skyscraper Reaches New Heights





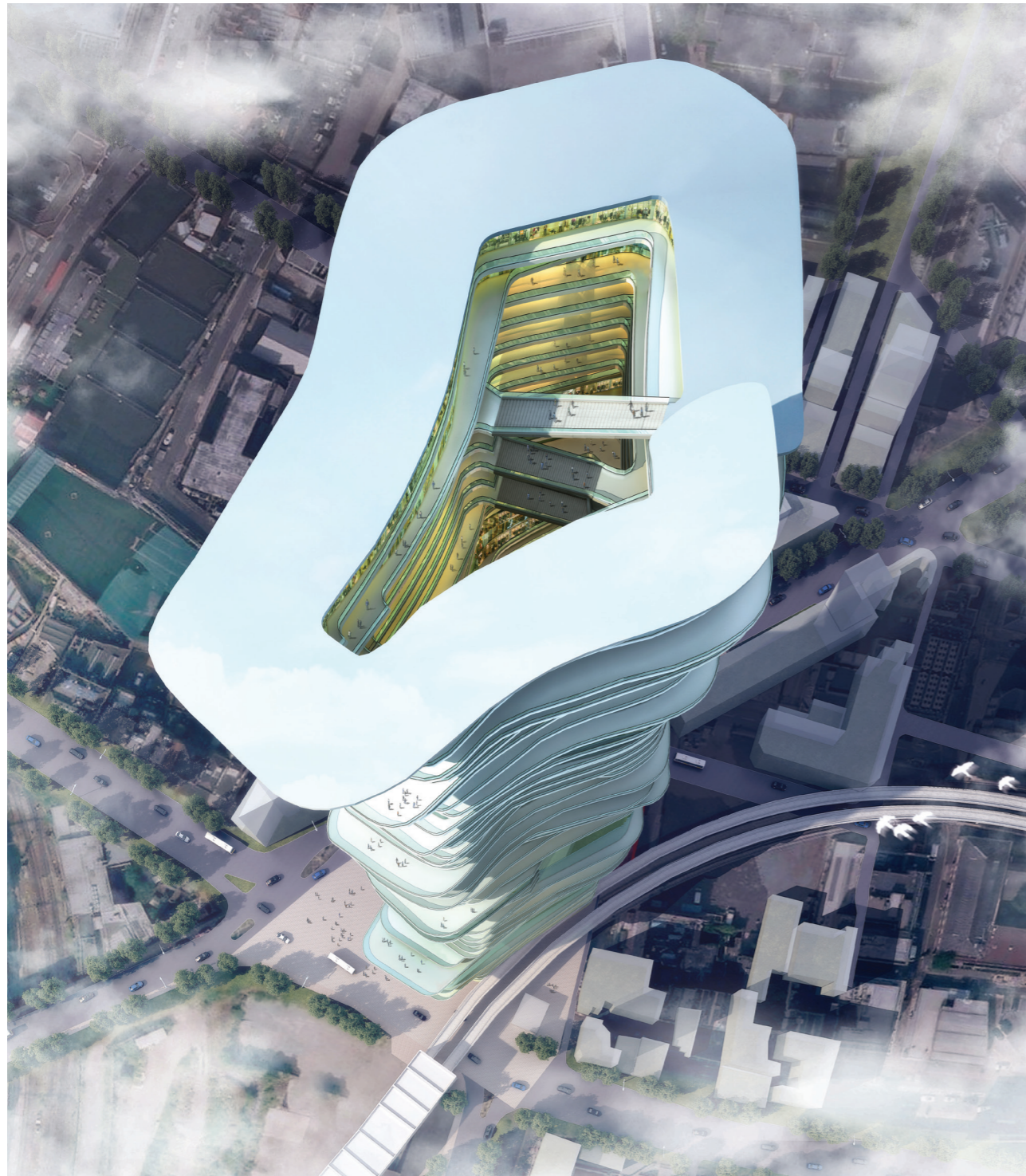

Spiralling upward, the City in Height challenges the traditional concept of a skyscraper. Created to resemble two ramps reaching for the sky, the new project redefines what's possible in the race for the clouds.



SURE Architecture developed the City in Height to represent an alternative to the traditional skyscraper design. Rather than superimposing one floor on top of another without any real sense of continuity, the project should instead be thought of as two endless ramps, circumrotating continually and rising gradually from the ground to the sky. The goal of the design was to conceive an open building that was an inviting and yet powerful symbol in all directions.

The different programs of the Tech City contained within are settled continuously along the two ramps. They face each other, are linked with bridges and interweave in a dynamic vertical and horizontal movement to increase exchanges, communication and interactions. The differentiated but interconnected spatial sequences of public and entertainment spaces create a lively, discussion-rich setting for conversations, and societal interaction and at the same time permit the creation of the vertical city. The irregular ramps create a variety of spaces and atmospheres. People discover the Tech City when they walk up the slopes through the commercial, vibrating streets, innovative and technological spaces, huge parks or public places all of which are linked to one another, creating a complex and rich system, just like a real city.

This vertical city comprises various plazas with individual character to create high pedestrian movement throughout the tower. From the most public to the most private of spaces, the area allows for a spectacular view of the building. Movement, spaces and light manifest themselves clearly as important and essential players in the overall production, providing the visitor a visually exciting environment, and a transition to the future.

Addressing the issue of sustainability, various parts of the system share and exchange ideas, energy, water and waste with each other, making up an ecosystem. Losses are minimized while reuse is optimized. The shape of the skyscraper itself is designed to maximize passive energy and reduce artificial lighting, ventilation and cooling needs. The building is also shaped by local constraints and orientations and contracted at the bottom to keep a distance from the nearest buildings and dilated at the top to let in natural light. Six structural steel tubes support the two ramps and enclose the activities and projects occurring within. These elements are directly assembled on the top of the building to vertically extend the six pillars and allow the skyscraper to exist within a green site. Each firm, shop and institution, recognizable from their own façade, can settle and evolve according to its needs. The rich variety of materials and textures reflects mixture of the City in height. The London skyline, with this organic skyscraper as a part of it, will transform, evolve and grow continuously together.